



**R·M·D
KWIKFORM**

**CLIMBING
FORMWORK**

people make the difference

RMD Kwikform is a powerful team comprising the skills, experience and energy of over 1,200 men and women in 16 countries. Totally diverse in nationality, culture, language and background. Totally united in the pursuit of customer satisfaction.



introduction

As a result of over 50 years experience working on major projects throughout the world, RMD Kwikform is unique in being able to offer two versatile climbing formwork systems – **Rapidclimb** and **Autoclimb**.

Rapidclimb is a crane assisted climbing formwork system, while **Autoclimb** is a hydraulic self climbing system, independent of crantage. Both can be used in conjunction with any modular or purpose made formwork.

At RMD Kwikform our customers requirements come first, and with our network of local branches, it means that when you deal with RMD Kwikform, you talk to people who understand the working environment, technical difficulties and challenges you face.



Client:
SIAC / Cleveland Bridge Joint Venture

Project:
Boyne Bridge, Ireland



Client:
Daewoo Samsung Joint Venture

Project:
LNG Tanks, Incheon, Korea



Client:
Di Pompo Construction Pty Ltd.

Project:
Queen Street Apartments, Brisbane, Australia



applications

RMD Kwikform climbing formwork systems can be configured for the concreting of virtually any tall structure.

Industrial Chimneys

- Silos
- High Rise Towers & Building Cores
- Bridge Piers & Pylons
- Airport Control Towers
- Telecommunication Towers
-

Client:
Robert McAlpine

Project:
Skyparks,
Edinburgh, UK

Client:
Consolidated Contractors
International Company
(C.C.I.C.)

Project:
Etisulat Building,
Abu Dhabi, UAE





Client:
Ting Kau
Contractors JV

Project:
Ting Kau Bridge,
Hong Kong



Client:
Consolidated Contractors
International Company
(C.C.I.C.)

Project:
LNG Building, Qatar

rapidclimb – some features and benefits

Rapidclimb is a crane assisted climbing formwork bracket system that provides safe self-contained working levels for economical wall core forming.

- Staged construction process **allows balance of site resources.**
- Rapidclimb anchor accessories can be reused after each pour, **reducing material costs on current and future construction programmes.**
- Trolley mounted formwork panel, retracts the form face, **providing space for cleaning and steel fixing of concrete.**
- Formwork & access platforms lifted as one, **minimising crane support; reducing labour and material costs.**
- Fine adjustments of the form face can be made during construction, **providing accurate alignment of the form face vertically & laterally.**



Client:
Taylor Woodrow
International

Project:
Flour Mill,
Screening Block,
Doha, Qatar



Rapidclimb Wall Bracket

Code	Description	Weight (Kg)
RCX10007	Wall Bracket	9.5

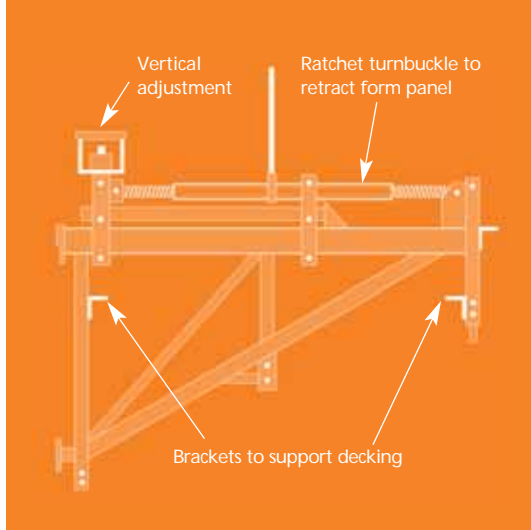

Rapidclimb Bracket

Code	Description	Weight (Kg)
RCX10003	Bracket	145.0



Rapidclimb Plumbing Turnbuckle

Code	Description	Weight (Kg)
RCX10005	Turnbuckle - Plumbing	16.7

Anchorage Options



Fixing of Wall Bracket to wall using Anchor Cone and bolt.



Alternative using recoverable RMD Kwikform Anchor screw.

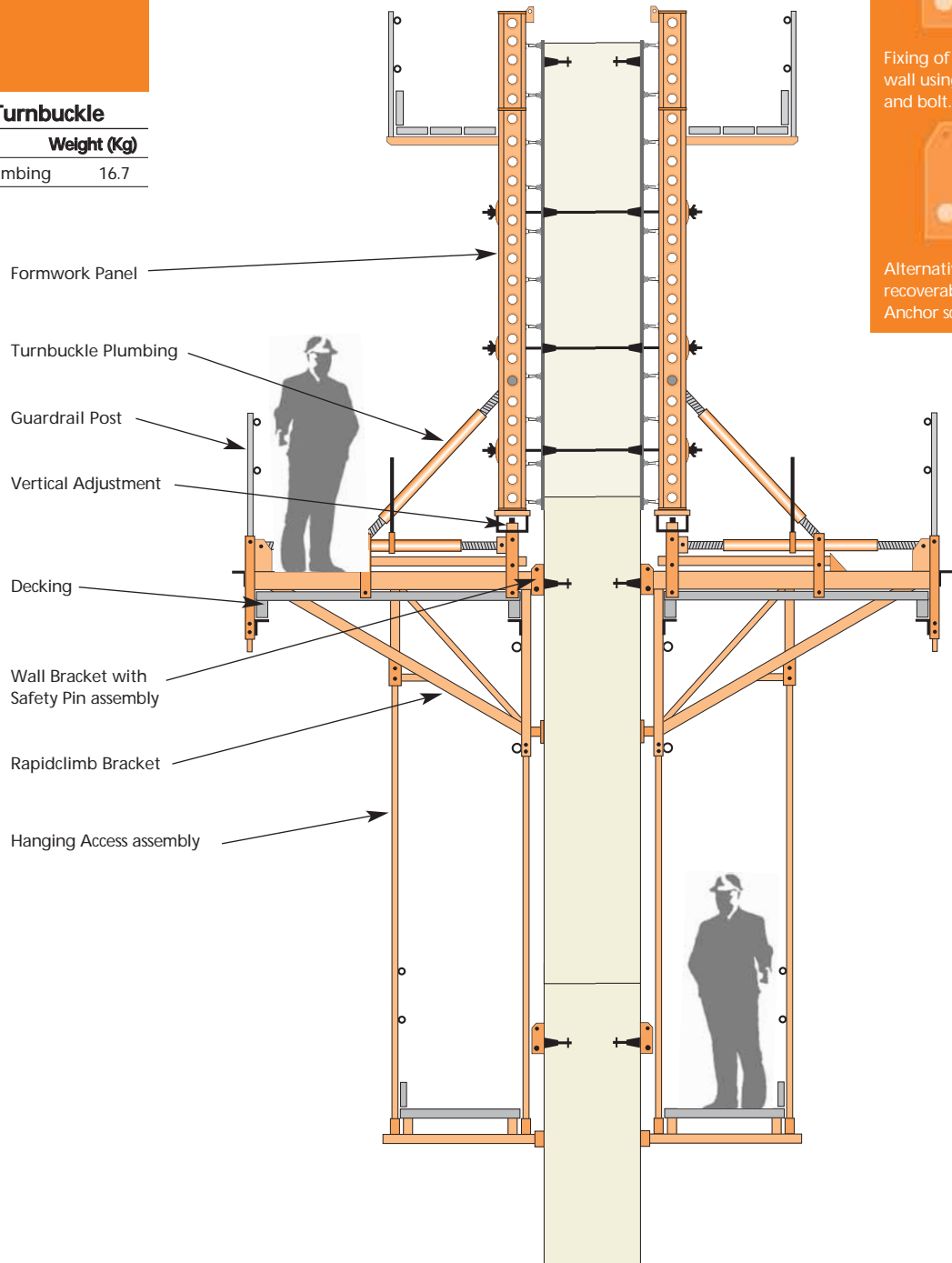



Client:
J. Laing
Construction Ltd.

Project:
Millennium Stadium,
Cardiff Arms Park, UK



The lower of a pair of climbing heads attached to the hydraulic ram, captivated around the pouter flange of the climbing mast

autoclimb – some features and benefits

Autoclimb is a self-contained climbing formwork system. Its unique design features allow it to climb up the concrete structure and subsequently lower itself to the ground after use.



200 bar hydraulic power unit and control console, capable of operating up to 4 lifting brackets, with automatic fail safe flow control

- Automatic lifting of formwork and brackets, **increases efficiency and eliminates requirement for a crane, reducing site labour, material costs and time.**

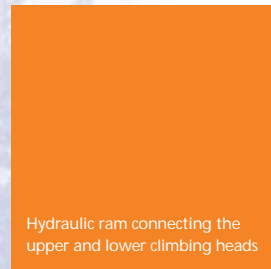

Hydraulic ram connecting the upper and lower climbing heads

- Hydraulic climbing system **enables large areas of formwork to be supported by each bracket.**

Ability to withstand wind

- speeds of 50 metres per second, **minimises delays to construction programme, due to inclement weather.**





Claws at the head of the climbing bracket, around the climbing mast



Easy to operate retracting trolley allows 680mm withdrawal of formwork



Client:
Robert McAlpine

Project:
Skyparks, Edinburgh,
UK



Client:
Di Pompo
Construction
Pty. Ltd.

Project:
Queen Street
Apartments, Brisbane,
Australia

Trolley mounted formwork panels can be retracted 680mm from the wall face, **providing space for steel fixing and cleaning of the form face.**

Autoclimb can be used on both vertical and inclined faces, **increasing the flexibility of applications.**

Autoclimb has a **built-in, additional safety** feature which limits the unforeseen event of the free fall of formwork to less than 200mm.



Autoclimb Wall Plate and Suspension Shoe Assembly

Code	Description	Weight (Kg)
ACX10042	Wall Plate	41.9
ACX10040	Suspension Shoe	24.2
ACX10046	Allen Key 22mm	0.83
ACX10045	Cap Screw M30 x 90	0.99
ACX10044	Anchor Cone Standard	4.0
ACX10003	Anchor Screw Extractor	3.0
ACX10004	Anchor Cone Plate Washer	2.9

Autoclimb Climbing Head Assembly with cylinder

Code	Description	Weight (Kg)
ACX10009	Climbing Head Assembly Top	39.5



Adjustable vertical connection of formwork to the retracting trolley



Autoclimb Climbing Mast Assembly

Code	Description	Weight (Kg)
ACX10010	Climb Mast 6.8m	279.0
ACX10011	Climb Mast Rest	2.26

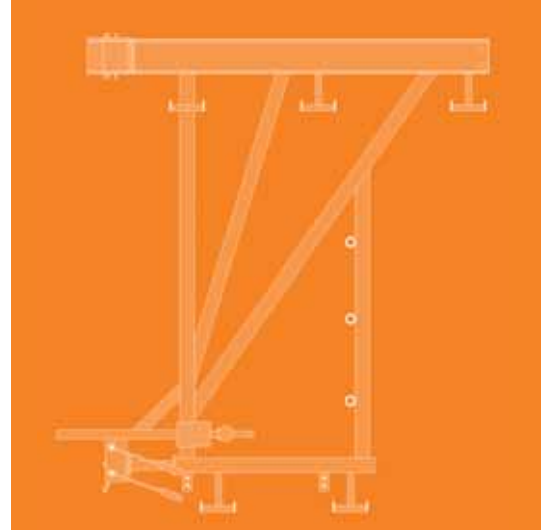

Autoclimb Climbing Bracket Assembly

Code	Description	Weight (Kg)
ACX10007	Climb Bracket Assembly	368.0

Autoclimb Hanging Access

Code	Description	Weight (Kg)
ACX10026	Hanging Access Post	5.0
ACX10027	Hanging Access Transom	5.0

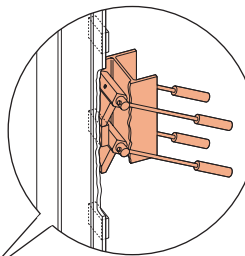
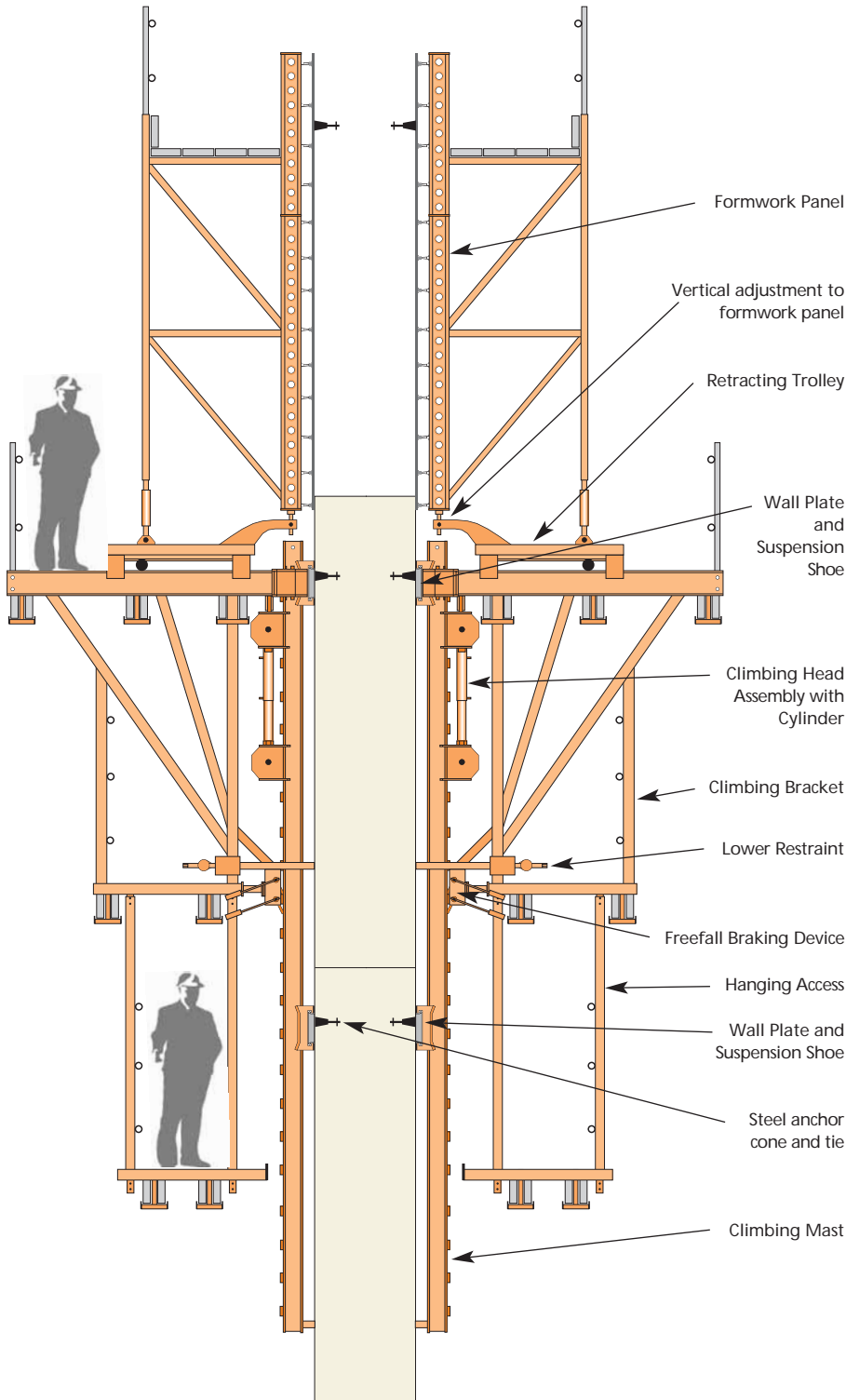

Autoclimb Retracting Trolley Assembly

Code	Description	Weight (Kg)
ACX10035	Return Trolley/ Assembly Top	10.0





people make the difference

RMD Kwikform is a powerful team comprising the skills, experience and energy of over 1,200 men and women in 16 countries. Totally diverse in nationality, culture, language and background. Totally united in the pursuit of customer satisfaction. These are some of RMD Kwikform's people. Work with them and their colleagues and you will discover the meaning of the word commitment.

As a group we are committed to the principles of the **"Investors in People"** charter, we conduct continuous programmes of training and personal development, ensuring that the future staffing needs of our business are fully met and the aspirations of our employees are fulfilled.

Partner in Vietnam

Diamond International Constructions
180/77/1 Nguyen Huu Canh Street
Ward 22, Binh Thanh District
Ho Chi Minh City, Vietnam

Tel: +84.8.62 899 677

Fax: +84.8.62 944 938

Email: info@diamond-constructions.com

Web: www.diamond-constructions.com

www.rmdkwikform.com

A member of Interserve Plc.